

## PRINT INSTRUCTIONS:

REFERENCE SHEET FOR EC-FF345 P/N 77-600045-001 REV 1.0 |

INK: BLACK | MATERIAL: 20 LB MEAD BOND | SIZE: 5.50" X 8.50" SCALE 1:1 |

FOLDS: TRI-FOLD VERTICAL, TRI-FOLD HORIZONTAL (TO FIT IN BOX)

# Vivint Smoke and CO Alarm Monitor

(EC-FF345)



4931 N 300 W Provo, UT 84604

## Quick Reference (User Manual – Install & Operation)

The Vivint Smoke and CO Alarm Monitor is designed to listen for any single alarm from any smoke, carbon, or combo alarm next to which it is installed. Once an alarm is confirmed, the monitor will transmit a signal to the control panel. When the system is connected to Vivint Monitoring, personnel, after verifying the signal, will dispatch the fire department.

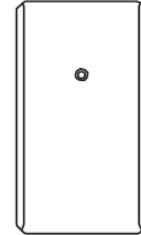

**WARNING:** This alarm monitor is intended only as a listening device *with* a smoke, CO, or combo alarm; it does not itself detect the presence of smoke, heat, or fire.

## Enrolling (see Image 1)

To enroll the monitor, set your panel into program mode (refer to your instruction manual for details). For panels with an automatic learn feature, press and release the learn button next to the tamper switch. Do NOT use the tamper switch to enroll.

1. To enroll for fire alarm monitoring, add a wireless zone and set panel into LEARN mode. Quickly press and release the learn button. This uses the 7-digit TXID (transmission ID) printed on the device. Add the device to the system using Loop 1 and program the panel zone type as either "FIRE" (type 09) or "FIRE WITH VERIFICATION" (type 16).
2. To enroll for CO alarm monitoring, add a wireless zone and set panel into LEARN mode. Press and hold the learn button for longer than 2 seconds. This uses the CO listening TXID that is one higher than the one printed on the device. Add the device to the system using Loop 1 and program the panel zone type as "CARBON MONOXIDE" (type 14).
3. Alternatively, the TXID can be manually entered into the panel. The number printed on the device is the TXID number for the smoke alarm detection portion, while the CO portion is one number higher. For example, if the TXID printed on the device is 034 5748, that is the correct TXID for smoke, while 034 5749 is the TXID for CO.

## Mounting (see Images 2 & 3)

Before mounting the monitor, verify that the smoke and/or CO alarm is not expired. Never install the monitor next to an expired alarm. Included with the monitor is a mounting bracket, hardware, and double-sided tape. For proper operation, make sure the side with the small holes is directly facing the sounder holes on the alarm. Secure the bracket to the wall or ceiling using the two screws and double-sided tape provided, then secure the audio monitor to the bracket using the small screw provided.

**IMPORTANT:** The monitor must be mounted within 6" of the smoke and/or CO alarm to ensure proper operation.

**WARNING:** Printed information describing proper installation, operation, testing, maintenance, evacuation planning, and repair service is to be provided with this equipment. Owner's instruction notice (located on smoke and CO alarms; not on the monitor): 'Not to be removed by anyone except occupant'.

## Testing (see Image 1)

During the first hour after power up (i.e., any time the batteries are replaced), the Smoke and CO Alarm Monitor is in test mode.

This allows you to use the test button on the smoke, CO, or combo alarm to test the system. After the first hour, the monitor requires at least two valid sound patterns from the alarm device in order to validate an alarm (which may not be possible via the alarm's test button). To test the RF transmission you can either generate a tamper by removing the cover, or press the learn button inside the device. This will send a signal to the panel. To test the audio detection and confirm that the device will send alarm signals to the monitoring station in the event of an alarm, press and hold the alarm's test button.

If you are using zone type 16 (Fire with Verification), you must press & hold the alarm button for at least 30 seconds to ensure the monitor has sufficient time to identify the alarm pattern and lock into alarm. Repeat for a CO (or combo) device if applicable. For combo devices, the alarm will typically sound the smoke temporal pattern, then the CO temporal pattern. In test mode the monitor will detect both, and send two transmissions to the panel. Ensure the cover is on, and that you wear hearing protection.

**NOTE:** This system must be checked by a qualified technician at least once every three (3) years. Please test the unit once per week to ensure proper functionality.

## Specifications

Frequency	345 MHz
Battery	One 3Vdc lithium CR123A (1550 mAh)
Battery Life	5 years under normal usage
Detection Distance	6 inches maximum
Operating Temperature	32° to 120°F (0° to 49°C)
Operating Humidity	5-95% Non-Condensing
Compatibility	2GIG and Honeywell receivers
Supervisory Signal Interval	64 minutes (approximate)
Maximum Current Draw	23mA during transmission

### Legacy Smoke Alarms

All smoke alarms should be replaced prior to the expiration date, or at least every 10 years. If you encounter an alarm that does not support Temporal 3 pattern, it should be replaced as per the manufacturer recommendation. If replacement is not an option, the monitor can be programmed to detect non-temporal alarms. **In this mode, the monitor must not be located near any other audible device, like a security keypad or sounder, as those can be misconstrued as a valid smoke alarm.** To enter this mode, press & hold the tamper switch while inserting the battery, then release the switch and note the LED behavior:

**ONE flash:** Only a Temporal 3 and Temporal 4 signal will trigger an alarm (Default).

**TWO flashes:** Generic listening mode (will trigger after 30 seconds of continuous 3K frequency sound).

**NOTE:** You can always verify the mode by simply removing the battery and replacing it. The LED will flash once or twice depending on the mode it is in. Repeat the steps above to change the mode as required.

### Replacing the Battery

When the battery is low, a signal will be sent to the control panel. To replace the battery:

1. Remove the top cover to reveal the battery. This will send a tamper signal to the control panel.
2. Replace with a Panasonic CR123A battery, ensuring the + side of the battery faces as indicated on the device.
3. Re-attach the cover, you should hear a click when the cover engages properly.

**WARNING:** While the Smoke and CO Alarm Monitor measures its own battery, it does not measure the battery in smoke alarms. Batteries should be changed as per the original smoke alarm manufacturer's instructions. Always test the monitor and smoke alarms after battery installation to confirm proper operation.

**Image 1 —**  
Enrolling / Test / Tamper

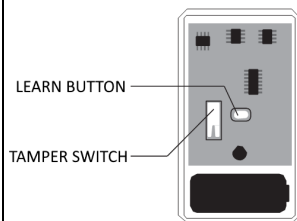

**Image 2 —**  
Installation Distance

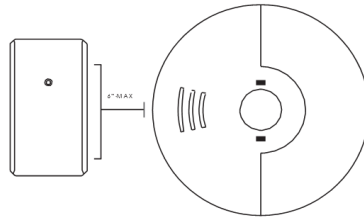

**Image 3 —**  
Side Markings



### WARRANTY

For the complete Vivint warranty and service plan, including details about terms and conditions, go to: [vivint.com/company/policies/terms-of-use](https://vivint.com/company/policies/terms-of-use)

**IMPORTANT:** The Vivint Smoke and CO Alarm Monitor does not detect the presence of smoke, heat, or fire directly. It relies solely on the presence of an audio alarm signal generated by an existing smoke or fire alarm in close proximity to the monitor to make such a determination. The monitor must be used with working smoke alarms certified according to UL Standards, and in strict accordance with the installation and operation instructions provided with such alarms. It is the owner's responsibility to ensure that smoke or fire alarms used in conjunction with the monitor are maintained and tested on a regular basis in accordance with the manufacturer's instructions. Vivint expressly disclaims any responsibility for the failure of the monitor to detect the presence of smoke or fire due to the failure of any smoke or fire alarm used in conjunction with the monitor to operate properly due to any condition, including improper installation, operation, maintenance or testing of such smoke or fire alarm.

### FCC and ISED Canada Regulatory Compliance Statement\*

**CAUTION:** Unauthorized changes or modifications could void the user's authority to operate the equipment.

This device has been tested and found to comply with the limits for a Class B digital device, pursuant to Part 15 of FCC Rules and Industry Canada license-exempt RSS standard(s). Operation is subject to the following two conditions:

- (1) This device may not cause harmful interference, and
- (2) This device must accept any interference received, including interference that may cause undesired operation of the device.

These limits are designed to provide reasonable protection against harmful interference in a residential installation. This equipment generates, uses, and can radiate radio frequency energy and, if not installed and used in accordance with the instructions, may cause harmful interference to radio communications. However, there is no guarantee that interference will not occur in a particular installation. If this equipment does cause harmful interference to radio or television reception, which can be determined by turning the equipment off and on, the user is encouraged to try to correct the interference by one or more of the following measures:

- Reorient or relocate the receiving antenna.
- Increase the separation between the equipment and the receiver.
- Connect the equipment into an outlet on a circuit different from that to which the receiver is connected.
- Consult the dealer or an experienced radio/television technician for help.

**FCC ID:** XQC-WST601, **IC:** 11455A-ECFF345

\*For complete regulatory compliance information, go to: [vivint.com/fcc](https://vivint.com/fcc)